



Self-closing patch fitting

# Alva

For glass doors in a class of their own



# Alva – Self-closing patch fitting in a class of its own

---

The Alva EN3 patch fitting has outstanding functionality and includes an integrated, adjustable back check ability to smoothly absorb the momentum of gusts of wind or when violently opening the door. With convenient installation options and sleek design, the Alva patch fitting is among the best in its class.

The fitting with EN5 closing force has the same dimensions (184 x 70 mm) as the EN3 patch fitting and therefore provides a uniform visual appearance of differently sized doors in the same room. It is particularly suited for wide and heavy doors.

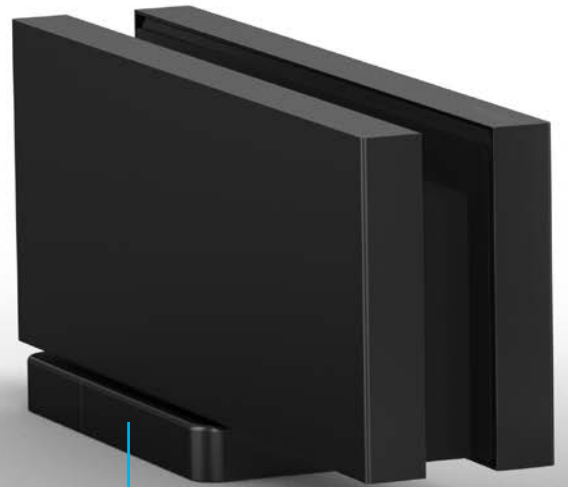

Installation without floor recess, the base plate is only fastened to the ground with two screws



Experience the Alva patch fitting on YouTube

Closing force	EN3	EN3 with back check function	EN5
Glass thickness tempered glass	8 - 12 mm	8 - 12 mm	10 - 15 mm
Size	184x70 mm	184x70 mm	184x70 mm
Door width	750-1000 mm	750-1000 mm	1000-1250 mm
Max. door weight	100 kg	100 kg	100 kg
Max. door height	2590 mm	2590 mm	2590 mm
Max. door opening angle	170°	150°	150°
Adjustable closing speed	170° - 15° / 15° - 0°	150° - 15° / 15° - 0°	150° - 15° / 15° - 0°
Closing cycles as/analogous per DIN EN 1154	500.000 cycles (ift Rosenheim)	500.000 cycles	500.000 cycles
Circumference	Indoor and roofed outdoor areas / averagely frequented doors		
Zero position	adjustable $\pm 3^\circ$		
Ambient temperature	-20° - +50°C		
Corrosion resistance class 3 according to DIN EN 1670	3		
Use	with possible stoppers		

Elegant design without visible attachment points



With black inserts

Fine adjustment of base plate



## CONVENIENT INSTALLATION

With Alva, floor recesses are a thing of the past. The fitting is fixed to the ground with only two instead of four screws and the aid of a base plate. To make drilling into the substrate as convenient as possible, there are 29 mm between the wall and the first drill hole, leaving enough space for vertical drilling.

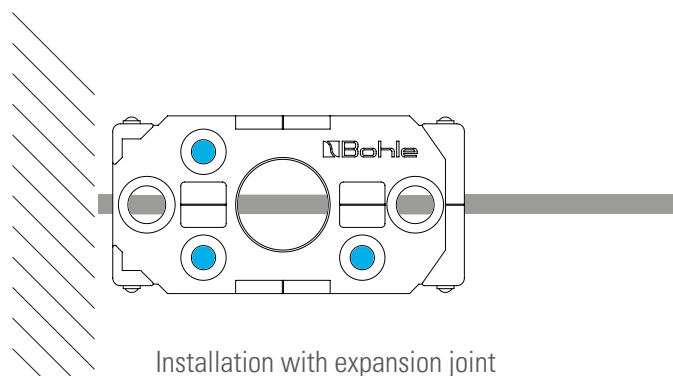
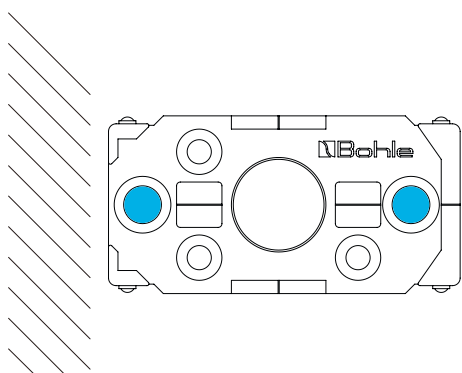

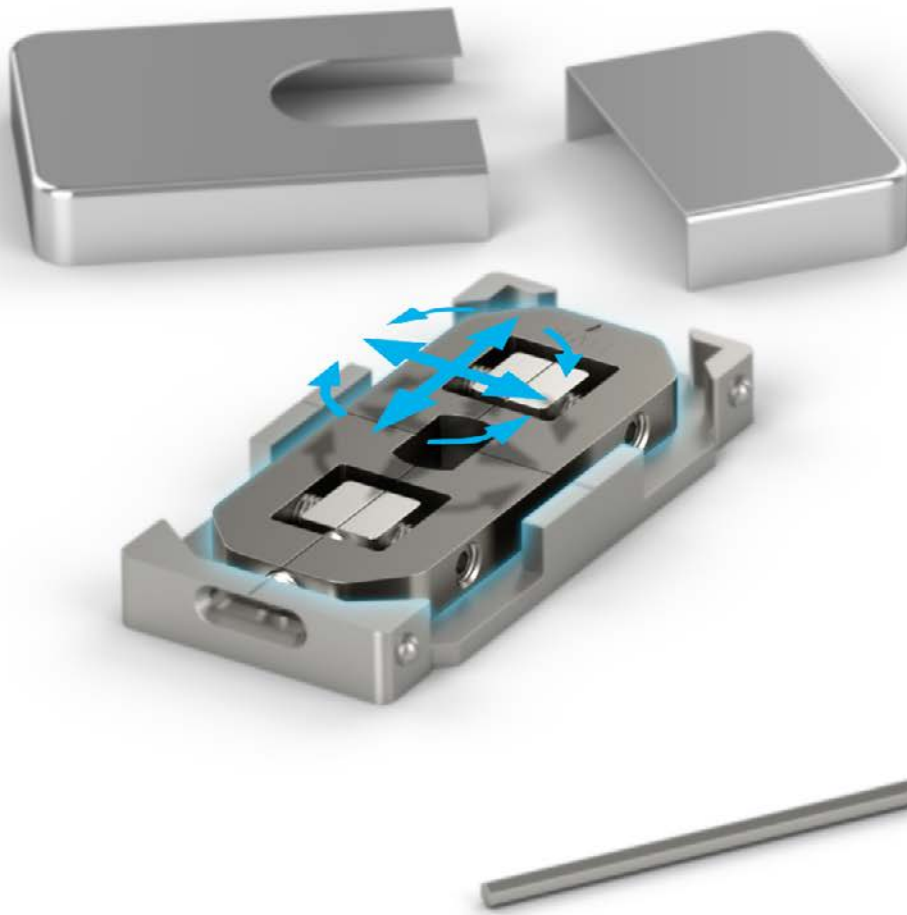

## FINE ADJUSTMENT OF THE BASE PLATE

The door is brought into an ideal position with the aid of four adjusting screws. This enables fine adjustment to the vertical alignment and the zero position, which can be adjusted by up to  $\pm 3$  mm /  $\pm 3^\circ$ . Wall distance and vertical alignment, can also be adjusted easily by  $\pm 3$  mm with the aid of a fifth adjusting screw.

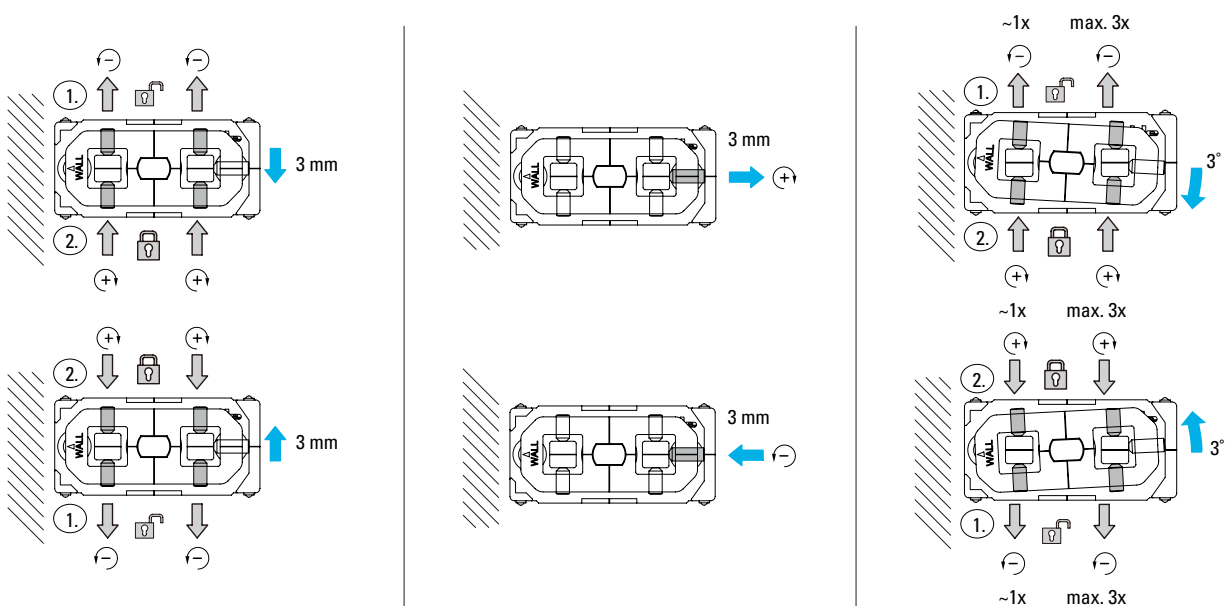



## ADJUSTABLE BACK CHECK FUNCTION FOR INCREASED SAFETY

---

For the first time, Alva patch fitting with EN3 closing force is equipped with an integrated, adjustable opening damper, the back check function, which safely and smoothly absorbs the momentum of gusts of wind or when violently opening the door. This is particularly recommended for adjacent walls. Both wall and glass door are protected in this way. The damping mechanism is adjusted with the aid of an additional valve. The back check function starts working from an opening angle of approx. 70° and can be adjusted continuously.





## CLEAR-CUT LINES, TIMELESS DESIGN

---

The straight-lined design delivers convincing performance. Thanks to the innovative plug-in fastening, there are no visible screws, fastening points or notches on the cover caps. Slightly rounded corners and black inserts create the impression of a shadow gap, emphasising the high-quality appearance of the system.

## Alva Self-closing Patch Fitting Set EN3 Including PT20 PLUS patch fitting and top pivot



CLOSING FORCE · HOLD POSITION · FINISH	ART. NO.
EN3 · 90° · brushed stainless steel	BO 5216626
EN3 · 90° · Matt black RAL 9005	BO 5216628

Max. door width	1000 mm
Max. door weight	100 kg
Material	stainless steel V2A
Max. door opening angle	170 °

**i** For averagely frequented buildings · Tested by the German ift Rosenheim testing authority with 500,000 cycles as per DIN EN 1154 · Continuously adjustable closing speed and latching mechanism 170° - 15° / 15° - 0° · Can be used with stopper · Suitable for indoor and roofed outdoor areas · Door width 750 - 1000 mm · max. door height 2590 mm · adjustable zero position ±3° · Glass thickness tempered glass 8 -12 mm · ambient temperature -20° - +50°C · Corrosion resistance 3 · Size 184 x 70 mm · Black inserts for all surfaces · Please note: Do not use with laminated safety glass

### INCLUDED IN DELIVERY:

- 1x Self-closing Alva Fitting EN3
- 1x Floor Mounting Plate
- 2x Plugs ø 10 x 30 mm
- 2x Screws M8 x 30 mm
- 1x Patch Fitting PT20 PLUS
- 1x Top Pivot



**More finishes can be achieved using cover caps**

## Alva Self-closing Patch Fitting EN3



CLOSING FORCE · HOLD POSITION · FINISH	ART. NO.
EN3 · 90° · brushed stainless steel	BO 5216606

Max. door width	1000 mm
Max. door weight	100 kg
Material	stainless steel V2A
Max. door opening angle	170 °

**i** For averagely frequented buildings · Tested by the German ift Rosenheim testing authority with 500,000 cycles as per DIN EN 1154 · Continuously adjustable closing speed and latching mechanism 170° - 15° / 15° - 0° · Can be used with stopper · Suitable for indoor and roofed outdoor areas · Door width 750 - 1000 mm · max. door height 2590 mm · adjustable zero position ±3° · Glass thickness tempered glass 8 -12 mm · ambient temperature -20° - +50°C · Corrosion resistance 3 · Size 184 x 70 mm · Black inserts for all surfaces · Please note: Do not use with laminated safety glass

### INCLUDED IN DELIVERY:

- 1x Self-closing Alva Fitting EN3
- 1x Floor Mounting Plate
- 2x Plugs ø 10 x 30 mm
- 2x Screws M8 x 30 mm





## Alva Self-closing Patch Fitting EN3 with back check function



FINISH · HOLD POSITION	ART. NO.
brushed · 90°	BO 5216691
brushed · without	BO 5216692
polished · 90°	BO 5216693
Matt black RAL 9005 · 90°	BO 5216694

Max. door width	1000 mm
Max. door weight	100 kg
Closing force	EN3
Material	stainless steel V2A
Max. door opening angle	150 °

**i** For averagely frequented buildings · tested as per DIN 1154 with 500,000 cycles · Continuously adjustable closing speed and latching mechanism 150° - 15° / 15° - 0° · Can be used with stopper · Suitable for indoor and roofed outdoor areas · Door width 750 - 1000 mm · max. door height 2590 mm · adjustable zero position ±3° · Glass thickness tempered glass 8 - 12 mm · ambient temperature -20° - +50°C · Corrosion resistance 3 · Size 184 x 70 mm · Black inserts for all surfaces · Please note: Do not use with laminated safety glass

### INCLUDED IN DELIVERY:

- 1x Self-closing Alva Fitting EN3
- 1x Floor Mounting Plate
- 2x Plugs ø 10 x 30 mm
- 2x Screws M8 x 30 mm

## Alva Patch fitting top PT20 PLUS



FINISH	ART. NO.
brushed	BO 5216610
polished	BO 5216611
Matt black RAL 9005	BO 5216612

**i** Suitable cover caps for self-closing Alva patch fittings EN3 and EN5 · with plastic bushing for 15 mm diameter pin · Glass thickness tempered glass 8 - 12 mm

## Alva Self-closing Patch Fitting Set EN5 Including PT20 PLUS HD patch fitting and top pivot



CLOSING FORCE · HOLD POSITION · FINISH	ART. NO.
EN5 · 90° · brushed stainless steel	<b>BO 5216681</b>
Max. door width	1250 mm
Max. door weight	100 kg
Closing force	EN5
Material	stainless steel V2A
Max. door opening angle	150 °
Hold position	90°

**i** For averagely frequented buildings · Continuously adjustable closing speed and latching mechanism 150° - 15° / 15° - 0° · Can be used with stopper · Suitable for indoor and roofed outdoor areas · Door width 1000 - 1250 mm · max. door height 2590 mm · adjustable zero position  $\pm 3^\circ$  · Glass thickness tempered glass 10 -15 mm · ambient temperature -20° - +50°C · Corrosion resistance 3 · Size 184 x 70 mm · Black inserts for all surfaces · Please note: Do not use with laminated safety glass

### INCLUDED IN DELIVERY:

- 1x Self-closing Alva Fitting EN5
- 1x Floor Mounting Plate
- 2x Plugs  $\varnothing$  10 x 30 mm
- 2x Screws M8 x 30 mm
- 1x Patch Fitting PT20 PLUS HD
- 1x Top Pivot

**More finishes can be achieved using cover caps**

## Alva Self-closing Patch Fitting EN5



CLOSING FORCE · HOLD POSITION · FINISH	ART. NO.
EN5 · 90° · brushed stainless steel	<b>BO 5216679</b>
EN5 · without · brushed stainless steel	<b>BO 5216680</b>
Max. door width	1250 mm
Max. door weight	100 kg
Material	stainless steel V2A
Max. door opening angle	150 °

**i** For averagely frequented buildings · Continuously adjustable closing speed and latching mechanism 150° - 15° / 15° - 0° · Can be used with stopper · Suitable for indoor and roofed outdoor areas · Door width 1000 - 1250 mm · max. door height 2590 mm · adjustable zero position  $\pm 3^\circ$  · Glass thickness tempered glass 10 -15 mm · ambient temperature -20° - +50°C · Corrosion resistance 3 · Size 184 x 70 mm · Black inserts for all surfaces · Please note: Do not use with laminated safety glass

### INCLUDED IN DELIVERY:

- 1x Self-closing Alva Fitting EN5
- 1x Floor Mounting Plate
- 2x Plugs  $\varnothing$  10 x 30 mm
- 2x Screws M8 x 30 mm

# Alva Patch fitting top PT20 PLUS HD



FINISH	ART. NO.
brushed	BO 5216617

**i** Suitable cover caps for self-closing Alva patch fittings EN3 and EN5 · with plastic bushing for 15 mm diameter pin · Glass thickness tempered glass 10 -15 mm

## Product details

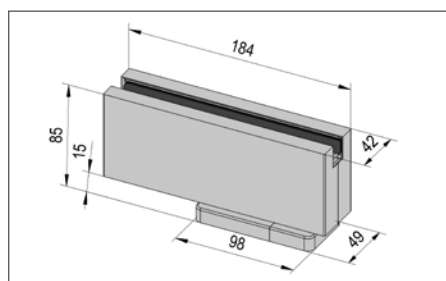

Alva EN3 / EN5

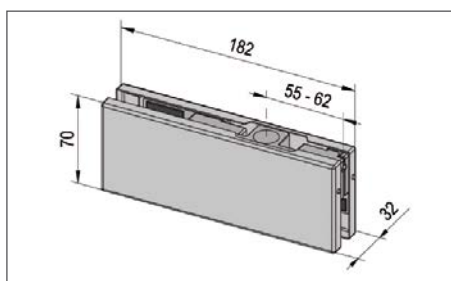

PT20 Plus

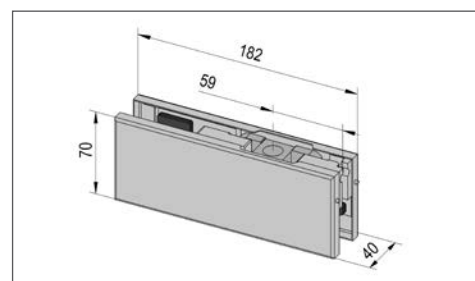

PT 20 Plus HD

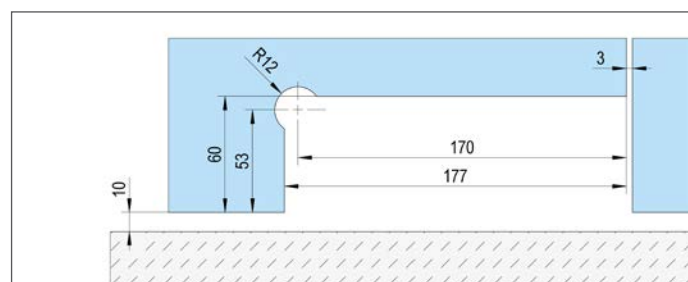
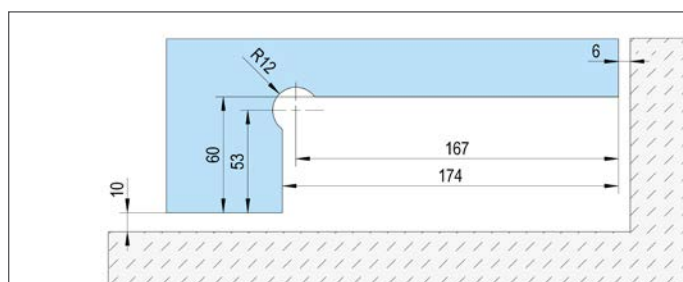
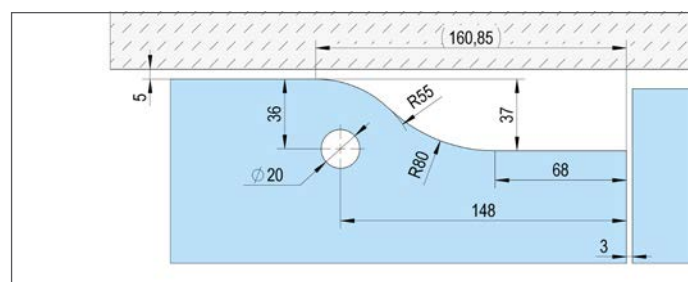
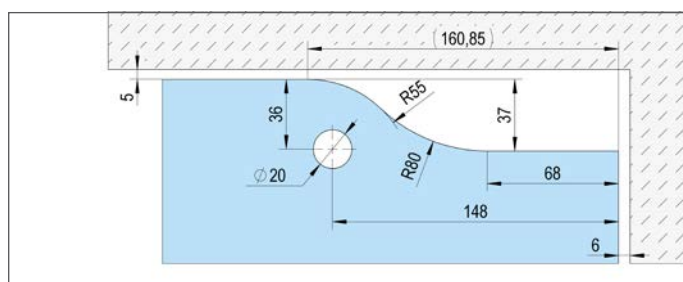
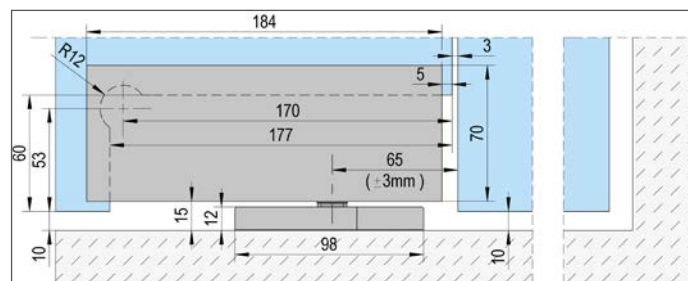
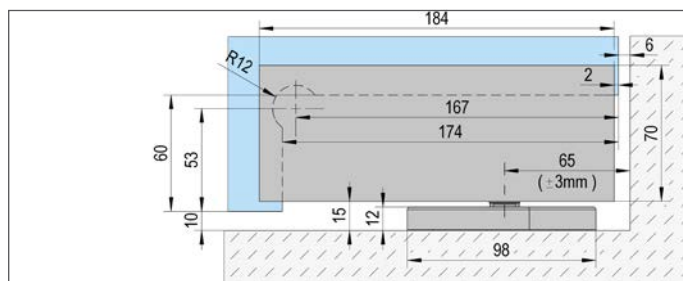

## Top Pivot PT 24



FINISH	ART. NO.
brushed	BO 5216615
polished	BO 5216616
black	BO 5216615B

Material	stainless steel V2A
----------	---------------------

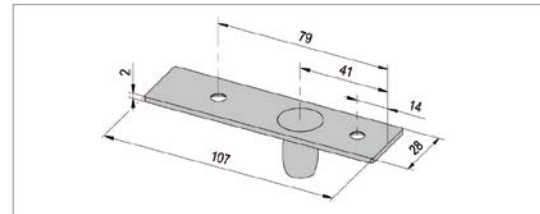

**i** Pin diameter 15 mm

## Cover Cap Set for Self-closing Alva Fitting EN3 and EN5



FINISH	ART. NO.
brushed	BO 5216635
polished	BO 5216636
Matt black RAL 9005	BO 5216637

Material	stainless steel V2A
----------	---------------------

**i** Suitable cover caps for self-closing Alva patch fittings EN3 and EN5

### INCLUDED IN DELIVERY:

- 2x Patch Fitting Cover Cap
- 2x Floor Mounting Plate Cover Cap

## Cover Caps for Alva Patch Fitting Set top PT20 PLUS / PLUS HD



FINISH	ART. NO.
brushed	BO 5216640
polished	BO 5216641
Matt black RAL 9005	BO 5216645

Material	stainless steel V2A
----------	---------------------

**i** Suitable cover caps for Alva patch fittings top PT20 PLUS and PT20 PLUS HD



# SUPPLEMENTARY PRODUCTS FOR ALL-GLAS INSTALLATIONS

## Patch fitting bottom PT 10



FINISH	ART. NO.
brushed	BO 5214266
Max. door width	1200 mm
Max. door weight	100 kg
Material	stainless steel AISI 304

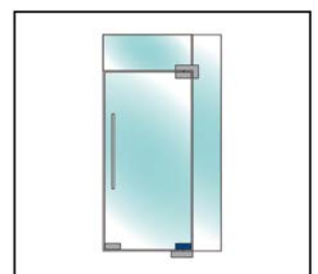
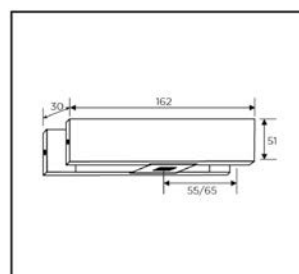

**i** With insert for flat conical axle · Adjustable pivot (55/65 mm) · Glass thickness tempered glass 10, 12 mm

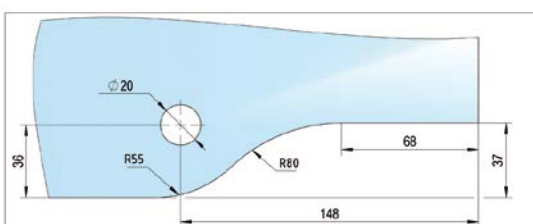



## Patch Fitting top PT20



FINISH	ART. NO.
brushed	BO 5214264
Max. door width	1200 mm
Max. door weight	100 kg
Material	stainless steel AISI 304

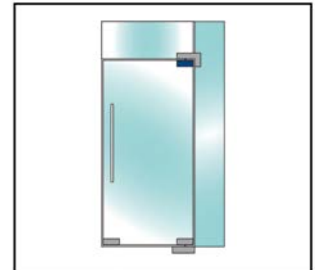
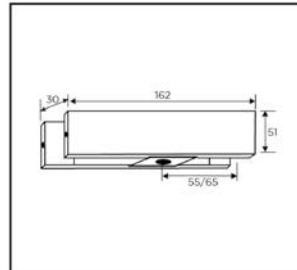

**i** With plastic bushing for 15 mm diameter pin · Adjustable pivot (55/65 mm) · Glass thickness tempered glass 10, 12 mm

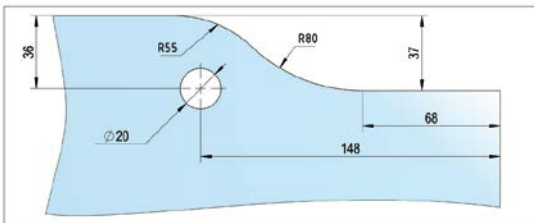

## Floor Pivot PT11



FINISH	ART. NO.
brushed	BO 5214288
Material	stainless steel AISI 304

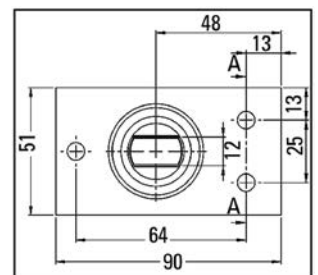
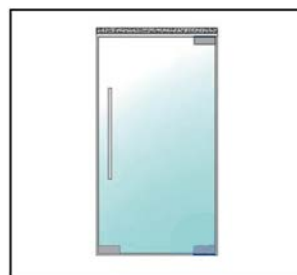

**i** Important: Please use a floor spring for closing the door automatically

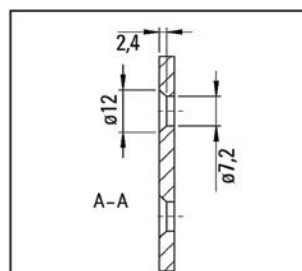
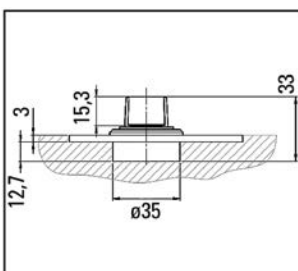

## Overpanel Fitting with Screw-on plate PT30.3



FINISH	ART. NO.
brushed	BO 5214267
Material	stainless steel AISI 304



**i** With pin  $\varnothing 15$  mm · Adjustable pivot (55/65 mm) · Glass thickness tempered glass 10, 12 mm · Mounting plate supplied loose

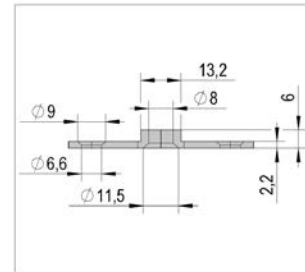
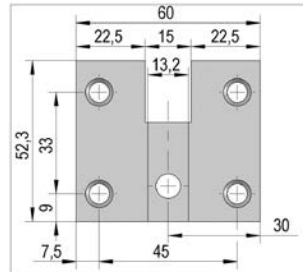
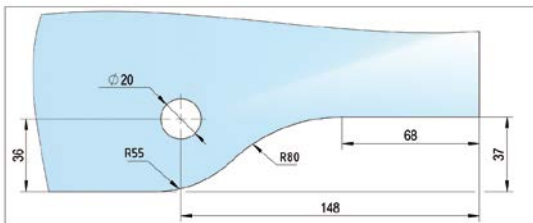

## Angled Overpanel Fitting PT40



FINISH	ART. NO.
brushed	BO 5214263
Material	stainless steel AISI 304

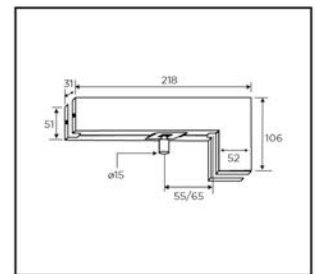

**i** With pin  $\varnothing 15$  mm · Adjustable pivot (55/65 mm) · Glass thickness tempered glass 10, 12 mm

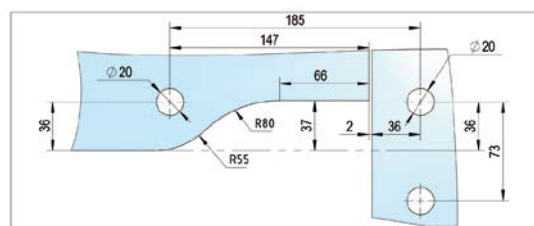
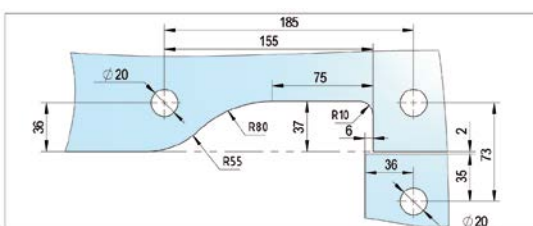

## Corner Clamp PT60



FINISH

brushed

ART. NO.

BO 5214271

Material

stainless steel AISI 304

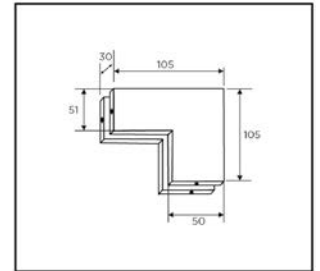
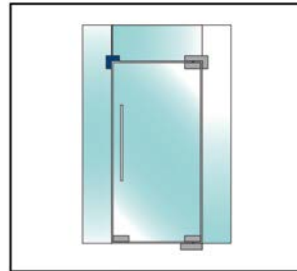

① Glass thickness tempered glass 10, 12 mm

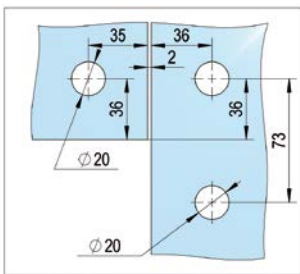

## Corner Clamp with Stopper PT61



FINISH

brushed

ART. NO.

BO 5214274

Material

stainless steel AISI 304

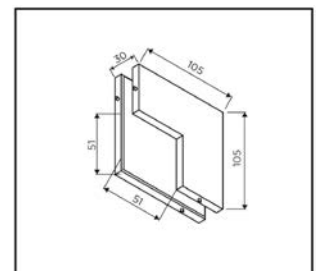
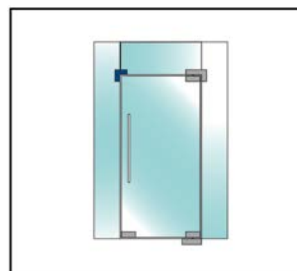

① Glass thickness tempered glass 10, 12 mm

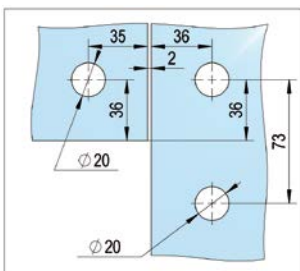

## Overpanel Connector with Stopper PT72



FINISH	ART. NO.
brushed	BO 5214260
Material	stainless steel AISI 304

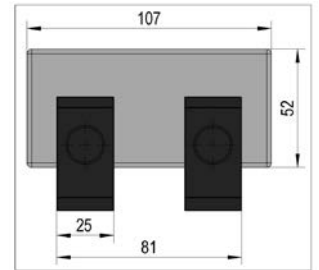
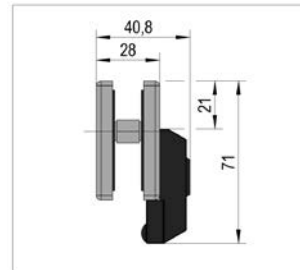

**i** Glass thickness tempered glass 10, 12 mm

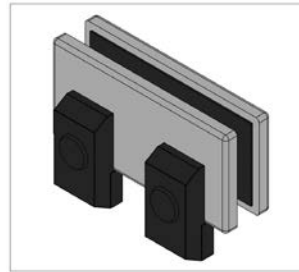
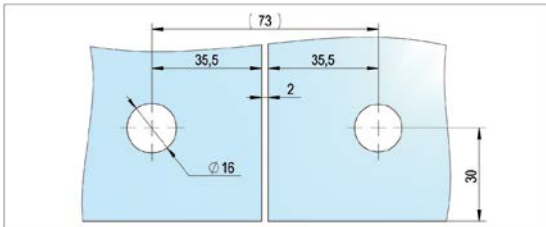

## glass/wall Connector PT90



FINISH	ART. NO.
brushed	BO 5214278
Material	stainless steel AISI 304

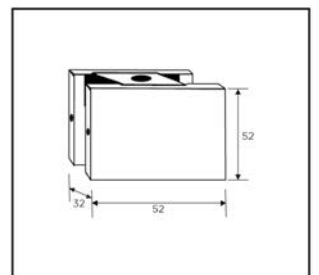
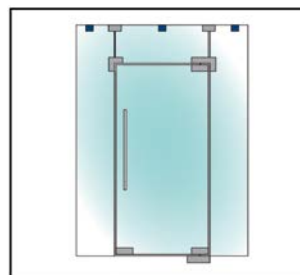

**i** Glass thickness tempered glass 10, 12 mm

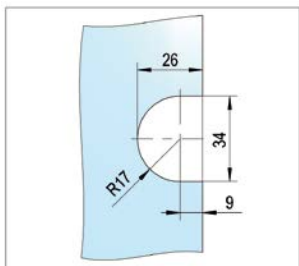

## Patch Lock with flat bolt US10



FINISH	ART. NO.
brushed	BO 5214280
Material	stainless steel AISI 304

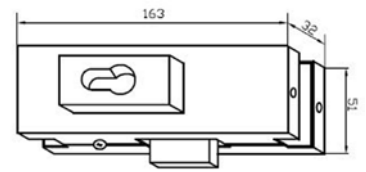

1 Euro profile cylinder (individual key) 60 mm (30/30) · incl. 4 keys · incl. strike plate and fixing screws · Glass thickness tempered glass 10, 12 mm

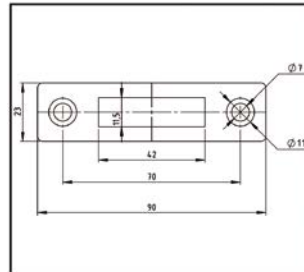
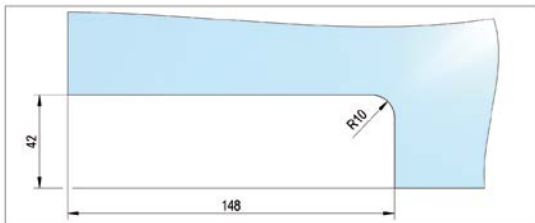

## Middle Lock with flat bolt US20



FINISH	ART. NO.
brushed	BO 5214281
Material	stainless steel AISI 304

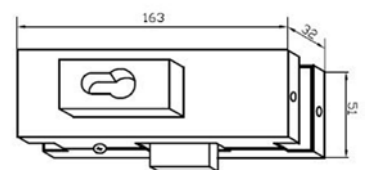
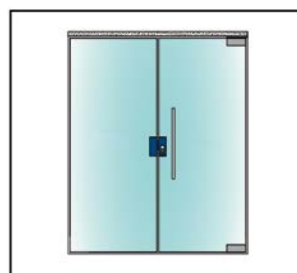

1 Euro profile cylinder (individual key) 60 mm (30/30) · incl. 4 keys · When used as a centre lock on double doors, one door must be used as a slave door · Glass thickness tempered glass 10, 12 mm

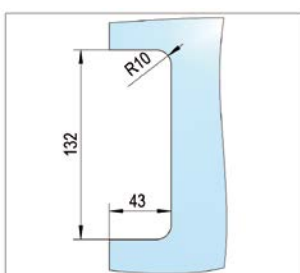



## Keep GK50



FINISH	ART. NO.
brushed	BO 5214282
Material	stainless steel AISI 304

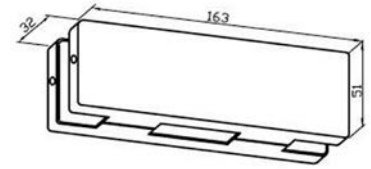
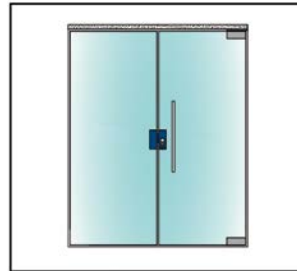

① Glass thickness tempered glass 10, 12 mm · When used as a centre lock on double doors, one door must be used as a slave door

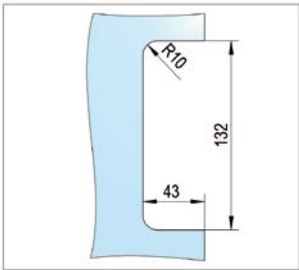

## Middle Lock with round bolt and one side rotating twist lock

FINISH	ART. NO.
brushed	BO 5214283
Material	stainless steel AISI 304

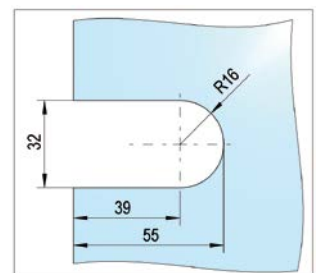
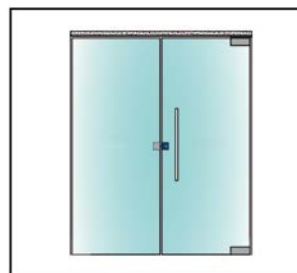

① When used as a centre lock on double doors, one door must be used as a slave door · Glass thickness tempered glass 10, 12 mm · Size 53 x 64 mm · Round bolt  $\varnothing$ 7 mm · single throw / 17 mm bolt projection · one-side lockable · incl. strike plate and fixing screws

## Keep



FINISH	ART. NO.
brushed	BO 5214284
Material	stainless steel AISI 304

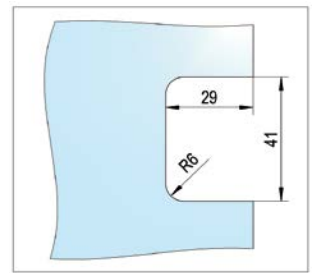
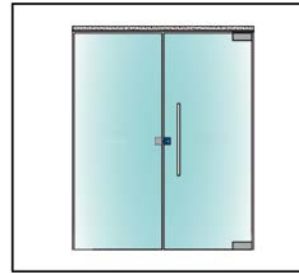

① When used as a centre lock on double doors, one door must be used as a slave door · Glass thickness tempered glass 10, 12 mm · Size 53 x 40 mm

## Lock with Profile Cylinder

The patch lock is equipped with a profile cylinder cover plate on one side and can be installed both in the upper and the lower corner area. The fitting is suitable for swinging, sliding and one-side opening doors made of glass.



FINISH	ART. NO.
Matt black RAL 9005	BO 5213850
brushed	BO 5213851
Material	stainless steel V2A

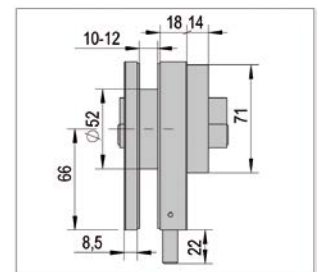
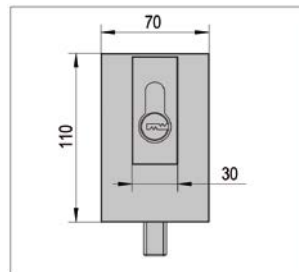

① Euro profile cylinder (individual key), 70 mm (35/35) · incl. strike plate, floor bush and fixing screws · Glass thickness tempered glass 10, 12 mm · one drill hole in the glass required

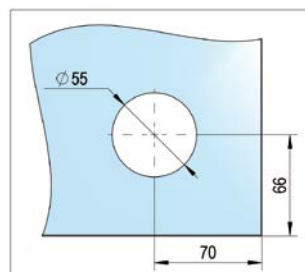
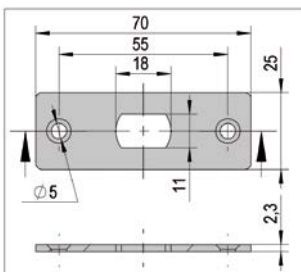

### INCLUDED IN DELIVERY:

- 5x Keys
- 1x Strike Plate
- 1x Floor Bush
- Fixing Screws

## Hook Lock with Keep and hook bolt



FINISH	ART. NO.
brushed	BO 5214285
Material	stainless steel AISI 304

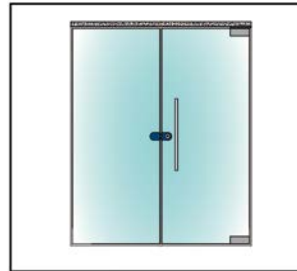

**i** When used as a centre lock on double doors, one door must be used as a slave door · No glass cutouts or drill holes required, clamp-on function · Glass thickness tempered glass 10, 12 mm · Deduction dimension glass-glass 6 mm · incl. 3 keys · individual key · Cylinder not exchangeable

## Hook Lock with Keep and hook bolt



FINISH	ART. NO.
brushed	BO 5214286
Material	stainless steel AISI 304



**i** When used as a centre lock on double doors, one door must be used as a slave door · No glass cutouts or drill holes required, clamp-on function · Glass thickness tempered glass 10, 12 mm · Deduction dimension glass-glass 5 mm · incl. 3 keys · individual key · Cylinder not exchangeable

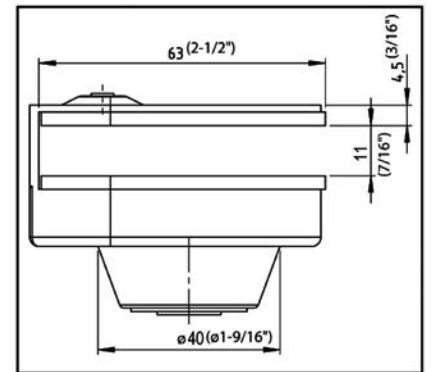
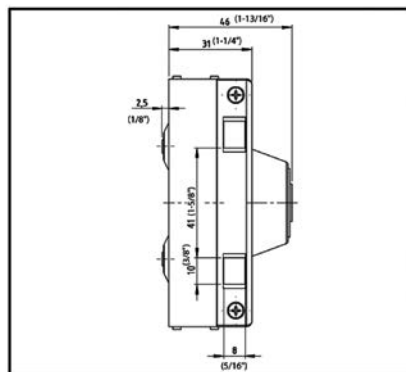
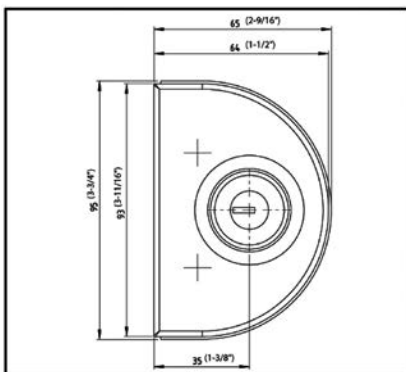

## Wall Connecting Profile



**i** No glass processing required · Easy mounting · different clamping parts for 8 to 12.7 mm glass · The profiles are pre-drilled

INCLUDED IN DELIVERY:

1x Wall Connecting Profile

	ART. NO.
	BO 5214290
Size	40 x 32 mm
Material	aluminium
Finish	mill finish
Length	3000 mm

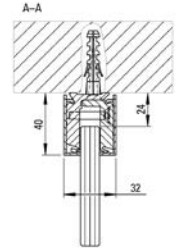
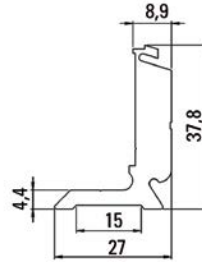

## Clamping Parts for Wall Connecting Profile incl. inserts and screw



**i** Suitable clamping part for wall connecting profile BO 5214290 · Packaging unit 1 pc · 10 pieces are needed for 3000 mm

INCLUDED IN DELIVERY:

1x Clamping Part  
2x Inserts  
1x Screw

DESCRIPTION	ART. NO.
for glass thickness 8 mm	BO 5214291
for glass thickness 10 mm	BO 5214292
for glass thickness 12 mm	BO 5214293
for glass thickness 12.7 mm	BO 5214294
Material	aluminium
Finish	mill finish
Length	60 mm

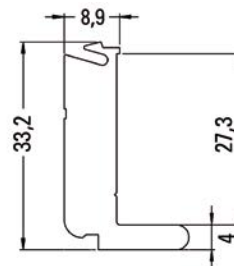

## Cover Profile for Wall Connecting Profile



FINISH	ART. NO.
aluminium-coloured anodised E4/EV1 brushed	BO 5214295
stainless steel look anodised E1/C31 brushed	BO 5214296
Material	aluminium
Length	3000 mm

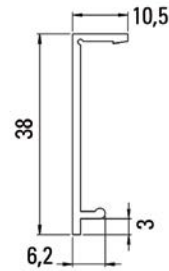

❶ Two are needed for each base profile (one front and one back) · Packaging unit 1 pc

INCLUDED IN DELIVERY:  
1x Cover Profile

## Handle type ø 19 mm

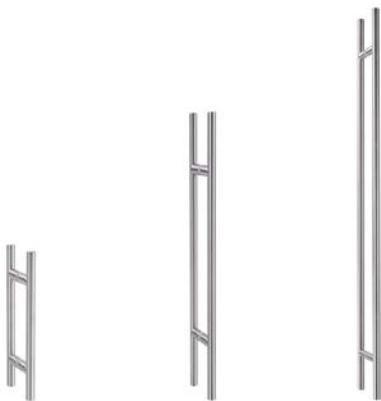

LENGTH (L) · DISTANCE BETWEEN HOLE CENTRES (C-C) · FINISH	ART. NO.
250 mm · 150 mm · brushed	BO 5213740
300 mm · 200 mm · brushed	BO 5213738
400 mm · 300 mm · brushed	BO 5213742
500 mm · 300 mm · brushed	BO 5213739
500 mm powder coated · 300 mm · black	BO 5213739B
600 mm · 500 mm · brushed	BO 5213745
800 mm · 600 mm · brushed	BO 5213746
1000 mm · 800 mm · brushed	BO 5213747
Width (ø)	19 mm
Depth (H)	52 mm
Material	stainless steel AISI 304
Glass thickness	6 - 12 mm
Glass processing	yes

❶ Modern, timeless design · Stainless steel with high quality brushed finish · For universal use: suitable for all all-glass sliding and swinging doors (e.g. MasterTrack FT / all-glass installation with patch fittings) · Complies with all visual requirements: Lengths between 300 mm and 2000 mm and three different diameters: ø19 mm, ø25 mm, ø32 mm · Drill hole in glass ø12 mm

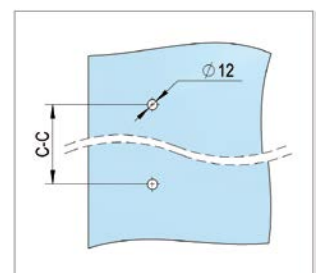
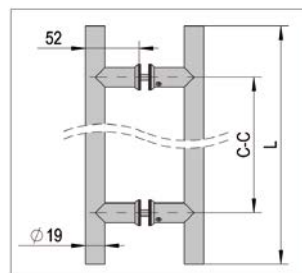

INCLUDED IN DELIVERY:  
Screws for doors up to 40 mm included (for use with: wood, steel, aluminium, plastic)



## Handle type $\varnothing$ 25 mm



**i** Drill hole in glass  $\varnothing$ 14 mm

LENGTH (L) · DISTANCE BETWEEN HOLE CENTRES (C-C) · FINISH	ART. NO.
300 mm · 200 mm · brushed	BO 5213749
400 mm · 300 mm · brushed	BO 5113701
500 mm · 400 mm · brushed	BO 5113702
500 mm powder coated · 400 mm · black	BO 5113702B
600 mm · 400 mm · brushed	BO 5113703
700 mm · 500 mm · brushed	BO 5113704
800 mm · 600 mm · brushed	BO 5113705
1000 mm · 800 mm · brushed	BO 5113706
1200 mm · 1000 mm · brushed	BO 5113707

Width ( $\varnothing$ )	25 mm
Depth (H)	65 mm
Material	stainless steel AISI 304
Glass thickness	6 - 12 mm
Glass processing	yes

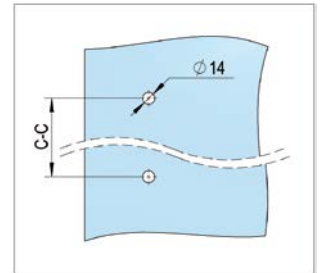
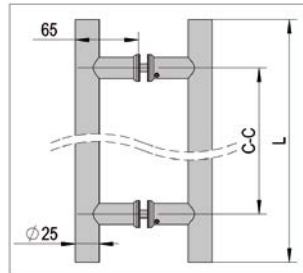

### INCLUDED IN DELIVERY:

Screws for doors up to 40 mm included (for use with: wood, steel, aluminium, plastic)

## Handle type $\varnothing$ 32 mm

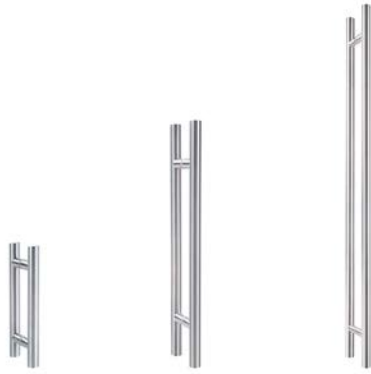

LENGTH (L) · DISTANCE BETWEEN HOLE CENTRES (C-C) · FINISH	ART. NO.
300 mm · 200 mm · brushed	BO 5113711
450 mm · 300 mm · brushed	BO 5213789
600 mm · 400 mm · brushed	BO 5213790
800 mm · 600 mm · brushed	BO 5113715
1000 mm · 800 mm · brushed	BO 5213779
1200 mm · 1000 mm · brushed	BO 5113716
1600 mm · 1000 mm · brushed	BO 5113717
1800 mm · 1000 mm · brushed	BO 5113718
2000 mm · 1000 mm · brushed	BO 5113719

**i** Drill hole in glass  $\varnothing$ 14 mm

Width ( $\varnothing$ )	32 mm
Depth (H)	72 mm
Material	stainless steel AISI 304
Glass thickness	6 - 12 mm
Glass processing	yes

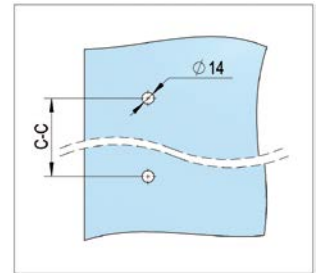
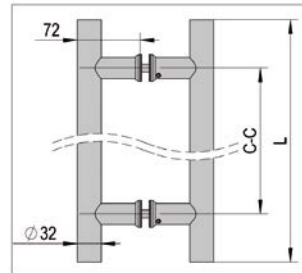

### INCLUDED IN DELIVERY:

Screws for doors up to 40 mm included (for use with: wood, steel, aluminium, plastic)

## Lockable Rod Handle

The lockable rod handle is a comfortable locking system with the lock positioned in a convenient, ergonomic height. It is well suited for all standard 30/160 Euro profile cylinders. The cylinder is easily exchangeable and can therefore simply be adapted to individual locking systems. Both double and knob cylinders can be used for this system. With a length of 1,900 (1,200) mm and a downward closing mechanism, the rod handle is universally applicable for sliding and swinging doors.



HANDLE TYPE · LENGTH (L)	ART. NO.
Handle type · 1200 mm	BO 5213346
Handle type · 1900 mm	BO 5213347
Cylinder lock without knob · 30/160 mm	BO 5213348
Cylinder lock with knob · 30/160 mm	BO 5213349

  

Width (ø)	35 mm
Depth (H)	77 mm
Distance between hole centres (C-C)	– mm
Material	stainless steel AISI 304
Finish	brushed
Glass processing	yes

**1** For 30/160 Euro profile cylinders (not included in delivery) · One floor sleeve per pair of handles included in delivery

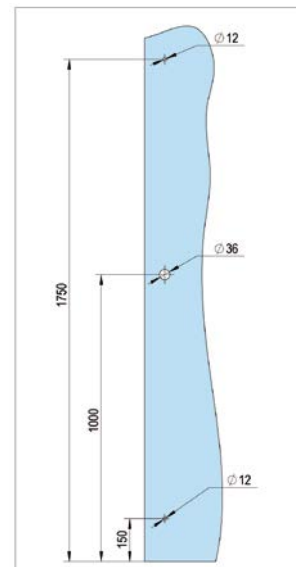
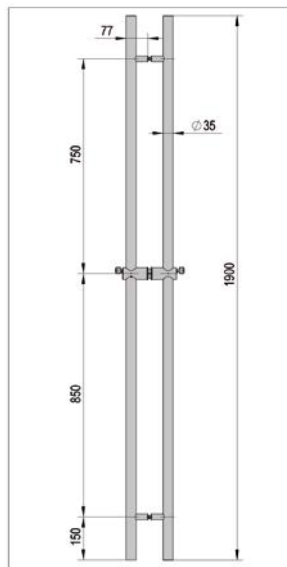
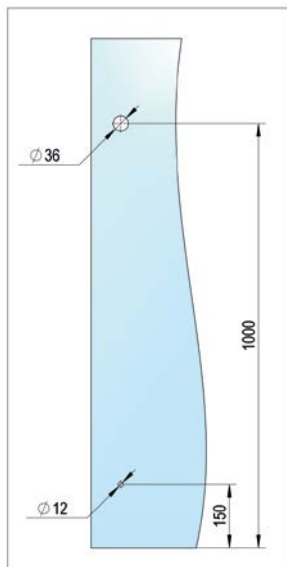
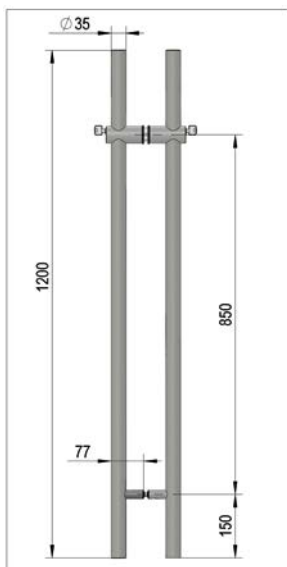

# Application Examples

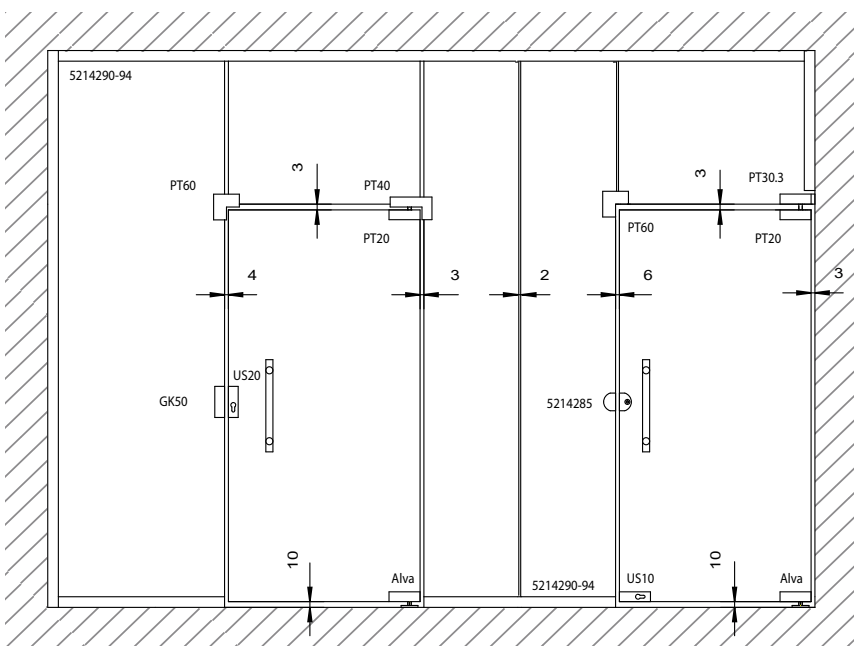
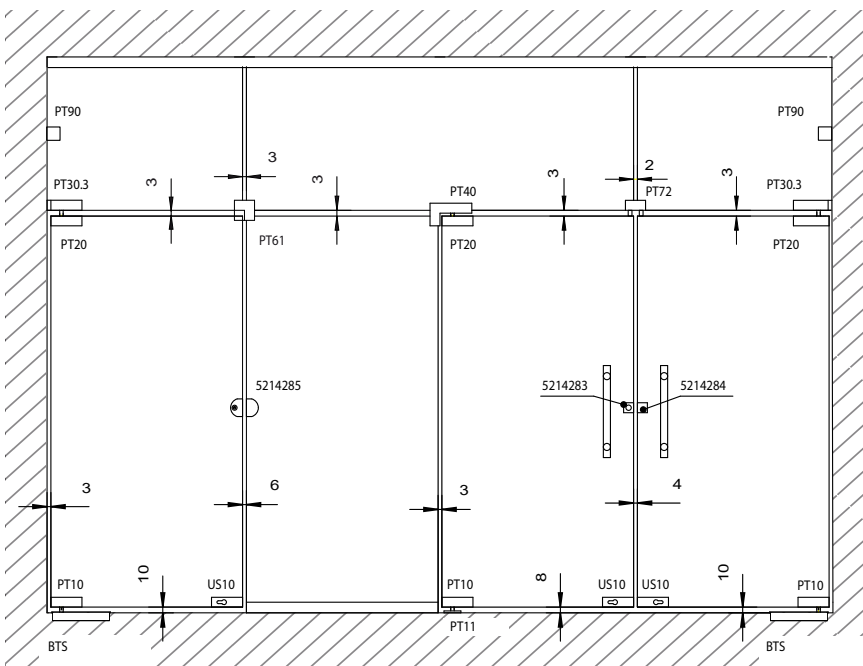
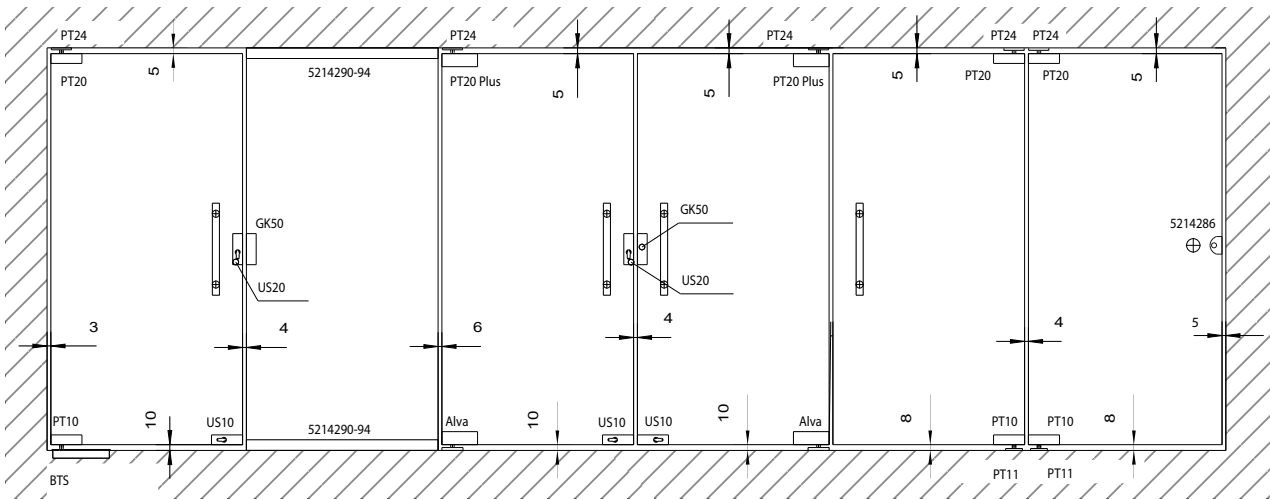



 Bohle

Bohle Ltd.  
Fifth Avenue  
Tameside Park  
Dukinfield  
Cheshire, SK16 4PP

T +44 161 3421100  
F +44 161 3440111

info@bohle.ltd.uk  
www.bohle.com

